

# Filter housing F20



[-> to the Product](#)

The F20 housing can be used for cleaning liquids or gases.

The housing can be used with filter elements made of nylon, sintered polyethylene, stainless steel, pleated or not. Most of them are available in different grades of micron rating.

This results in a wide range of applications.

### Applications:

- Filtration in laboratory and analytical conditions
- Filtration in photochemical processes
- Protection of pneumatic control systems
- Pre-filter in the medical field
- Circulation filters for cooling devices
- Pre-Filter for measuring instruments
- Particle filters for laser cooling systems

### Available accessories

- Wrench

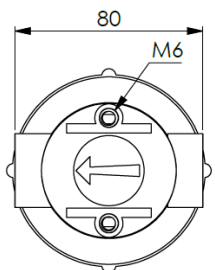
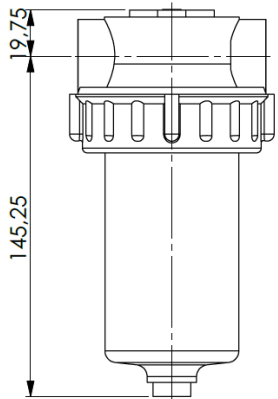
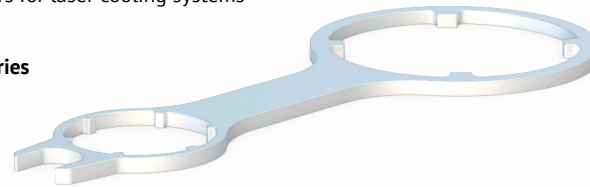

### Flow Rate

Material	Micron rating	Liter/h
Polyethylene	5 µm	140
	10 µm	210
	25 µm	350
Nylon:	50 µm	440
	100 µm	540
	150 µm	620
	200 µm	680
	350 µm	800
ΔP 0,2 bar (related to water)		

### Technical Data

Material:	Head made of glass-fibre reinforced polypropylene, lower part made of SAN (transparent) or glass fibre reinforced polypropylene
Working pressure:	0 to +10 barg
Working temperature:	+5 to +30°C
In-/Outlet:	1/4", 3/8" and 1/2" female thread DIN ISO 228 G/ BSPP
Gasket:	NBR (other on demand)
Mounting:	2 x M6 on top of filter head

### Order information

#### 1) Filter housing

F20  B.  /17

In-/Outlet	
13	1/4" female thread
17	3/8" female thread
21	1/2" female thread

Lower part	
360	transparent (SAN)
310	blue (Polypropylene)

Order example: F2017B.360/17

### Order Information

#### 2) Filter elements

F20-	<input type="text"/>			
	Polyethylen	Nylon		Stainless steel
5PE	5 µm	50N	50 µm	140ES 140 µm
10PE	10 µm	100N	100 µm	220ES 220 µm
25PE	25 µm	150N	150 µm	
		200N	200 µm	
		350N	350µm	

Order example: F20-140ES